

#### FROM OUTSIDE THE OFFICE

1. From any Internet Browser, go to [vdi.winstead.com](http://vdi.winstead.com).
2. Log in using your network user name and password.

**Note:** You will get an informational alert like this:

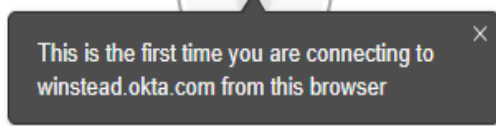
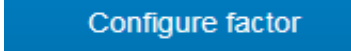

1. Click 
2. Choose your **phone** type (iPhone, Android, or Windows mobile device):

Select your device type

- iPhone  
 Android

3. Install the Okta application on your mobile device.

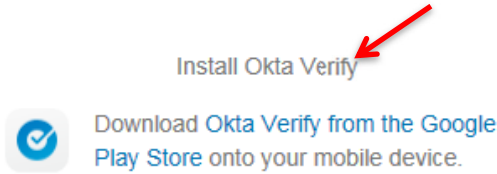

4. Launch the application on your mobile device and select **Add an account**. The Okta application will open the camera on your phone.
5. Return to the browser on your computer and click the **Next** button.
6. Place your phone near the computer screen in order to scan the QR code on your browser.

#### Setup Okta Verify

Scan barcode

Launch Okta Verify application on your mobile device and select Add an account.



Can't scan?

7. If you wish to set up **SMS (text) Authentication**, click **Setup**. Otherwise, click **Finish**.

#### Set up multifactor authentication

You can configure any additional optional factor or click finish

Enrolled factors



Additional optional factors

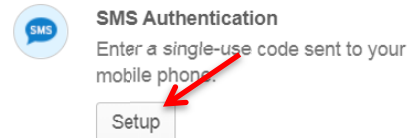

8. Click "Click here" to complete the login process. (See image on the next column)

Access was denied by the access policy. This may be due to a failure to meet access policy requirements.

If you are an administrator, please go to Access Policy >> Reports : All Sessions page and look up the session reference number displayed above.

To open a new session, please [click here](#).

9. Choose the option below:

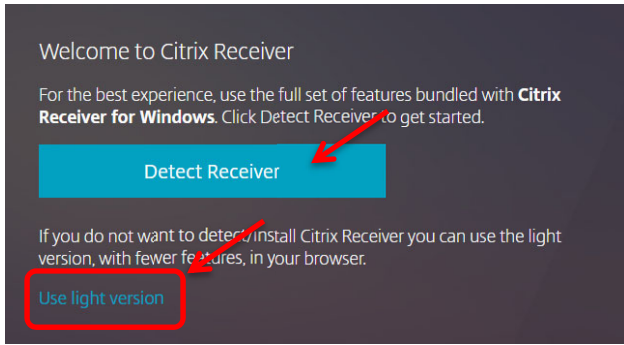

- **Detect Receiver** – If this is a company issued machine or Citrix has already been installed.
- **Use Light Version** – If this is a public machine and/or you do not have administrative access to install applications to the computer.

10. Check the box stating you agree to the Citrix License Agreement.

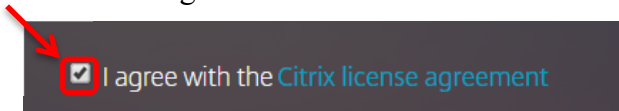

11. Choose the option below:

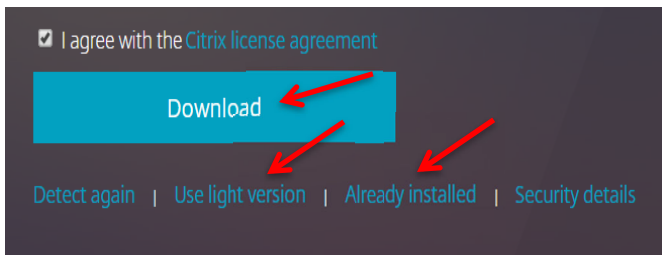

- **Download** – If Citrix Receiver has not been installed.
- **Already Installed** – If Citrix Receiver has already been installed.
- **Use Light Version** – If you do not have permission to install any applications on the computer.

12. If VDI does not launch automatically, click on



WVDI10

the VDI icon.

## Logging In Remotely

1. Using any Internet Browser, go to [vdi.winstead.com](http://vdi.winstead.com)
2. Log in using your network user name and password.

**Note: You may get an informational alert like this:**

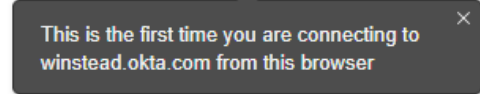

3. Check the box titled “**Do not challenge me on this device again**” to “**trust**” the computer. Once trusted, the computer will not require 2FA again.

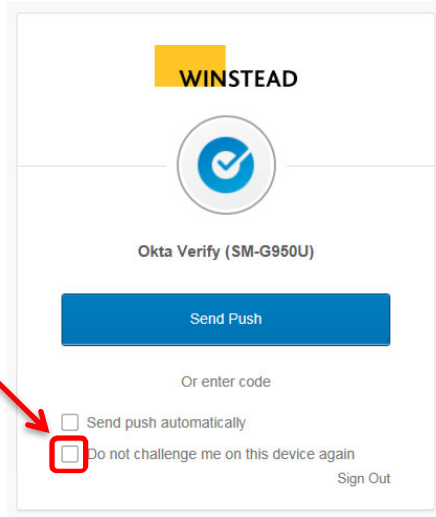

1. Click
2. On your mobile device, click **Approve**.

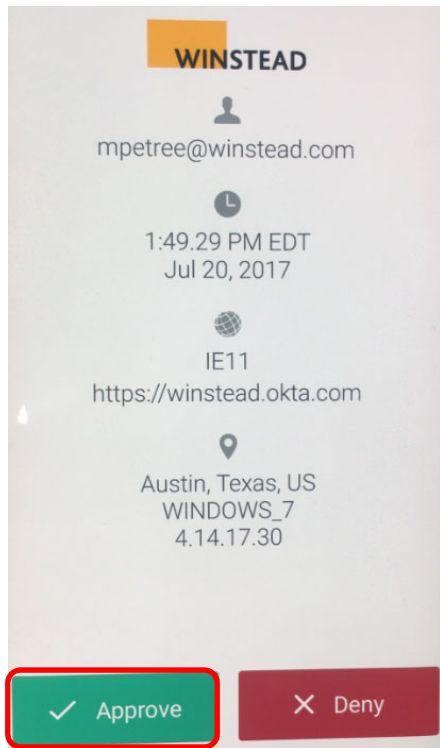

3. If VDI does not launch automatically, click on the



VDI icon. `wvdi10`

## Resetting/New Device

If you have a replacement phone/device you will need to contact the Support Center to have the old phone/device removed before the new one can be registered. Once the old device has been removed, you will need to follow the steps in **Setting Up Okta Verify**.